

**MERCUISER**  
**Generation II**  
**Lower Gearcase Assembly**

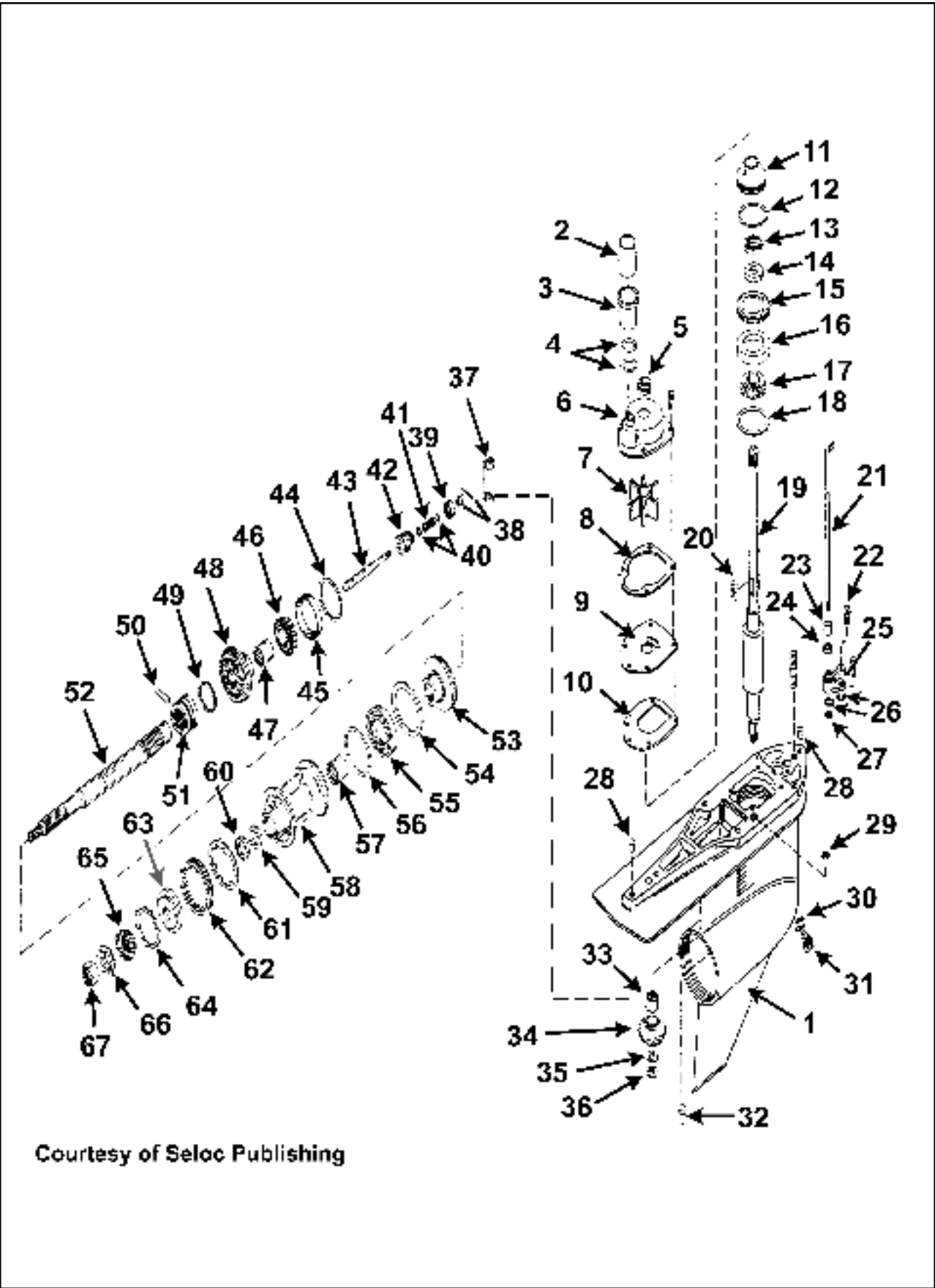

Courtesy of Seloc Publishing



# MERCUISER

## Generation II

### Lower Gearcase Assembly

Description	O.E. #	Sierra #	AP #	Description	O.E. #	Sierra #	AP #
1. Gear Housing ....	1623-815822A30	—	—	34. Pinion Gear .....	43-828072A2	—	—
2. Sleeve .....	23-816573	—	—	35. Washer .....	12-92721	18-2343	—
3. Coupling .....	816597A1	18-2353	2639	36. Nut .....	11-35921	18-3719	2678
4. O-Rings .....	25-21836	18-7420	2109	37. Shift Crank .....	76865	18-2130	2630
5. Face Seal .....	26-816575A2	18-2599	2106	38. Cotter Pin & Sleeve .....	818349A1	18-2286 ①	2416
6. Water Pump Body .....	817275A1	—	—	39. Retainer .....	818349A1	18-2286 ①	2416
7. Impeller .....	47-43026-2	18-3056	1814	40. Washers .....	818349A1	18-2286 ①	2416
8. Gasket .....	27-817277	18-2563	1484	41. Spring .....	818349A1	18-2286 ①	2416
9. Face Plate .....	817276	18-3122	2187	42. Shift Spool .....	818349A1	18-2286 ①	2416
10. Gasket .....	27-43033-1	18-2564	1483	43. Clutch Shaft .....	818349A1	18-2286 ①	2416
11. Seal Carrier .....	821759A2	18-2354	2638	44. Shim(S) .....	15-47397A1	18-2285	—
12. O-Rings .....	25-90011	18-7174	274	45. Bearing Cup .....	31-35928A1	18-1159	570
13. Seal .....	26-16977	18-2013	174	46. Bearing .....	31-35928A1	18-1159	570
14. Seal .....	26-89238	18-2014	171	47. Roller Bearing .....	31-30895	18-1157	2125
15. Cover Nut .....	824519	18-2346	2698	48. Forward Gear .....	43-828072A2	—	—
16. &				49. Cross Pin Spring .....	24-30893	18-2348	—
17. Bearing Cup .....	31-36387A1	18-1143	13029	50. Cross Pin .....	17-30632	18-2357	2682
18. Shim(s) .....	15-42637A1	—	—	51. Sliding Clutch .....	52-824112	18-2202	2415
19. Drive Shaft (1.50-1.65 Ratio) .....	45-816919	18-2261	2739	52. Propeller Shaft .....	44-824110	18-2166	—
19. Drive Shaft (1.84-1.98 Ratio) .....	45-816472	—	—	53. Reverse Gear .....	43-828072A2	—	—
20. Impeller Drive Key .....	28-43037	18-3293	2677	54. Thrust Ring .....	681001	18-2342	—
21. Shift Shaft .....	815919A1	18-2320	2642	55. Ball Bearing .....	30-88957A1	18-1155	1900
22. Speedometer Pickup Fitting .....	—	—	—	56. O-Ring .....	25-31534	18-7159	217
23. Sleeve .....	23-67370	—	2675	57. Roller Bearing .....	31-30956	18-1158	2126
24. Seal .....	26-89236	18-2009	172	58. Bearing Carrier .....	818763A10	18-2376	2635
25. Shift Rod Bushing Assembly .....	23-815921A21	18-2353	3742	59. Seal .....	26-14077	18-2002	238
26. O-Rings .....	25-36318	18-7491	2110	60. Seal .....	26-12224	18-2076	1439
27. Retaining Ring .....	53-29641	18-4295	—	61. Tab Washer .....	14-18323	18-2298	2634
28. Dowel Pin .....	17-43044	—	—	62. Cover Nut .....	79448	18-3751	1117
29. Seal .....	26-45577	18-2944	221	63. Thrust Hub .....	13171	18-4220	1192
30. Gasket .....	12-19183	18-7420	2108	64. Continuity Washer .....	13-42351-1	—	—
31. Plug .....	22-67892A1	18-2375	2683	65. Splined Washer .....	12-31211A2	18-3714	2668
32. Pin .....	17-37972-1	—	—	66. Tab Washer .....	14-31210	18-3200	2708
33. Pinion Bearing .....	31-42647A1	18-1117	2762	67. Propeller Nut .....	11-52707	18-3700	122
				68. Carrier Anode .....	806105A1	18-6093	4014 ②
				Seal Kit .....	26-816575A3	18-2646-1	834
				(Not Pictured)			

① Pieces not sold separately, must be purchased as 18-2286/AP# 2416. Kit consists of figure numbers 38-43

② Also available in bulk pack of 10 pieces (AP# 4014B)

For Water Pump Kit use 18-3147 Mercruiser # 817275T4

